

LWTD8686D Temperature Controller Operation Manual

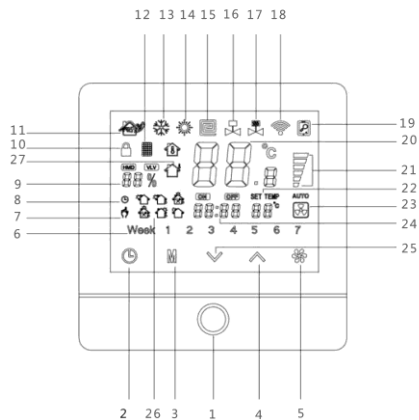

Functional Description



9	Temperature display area
10	Child lock
11	Ventilation mode
12	Filtering icon
13	Refrigeration mode icon
14	Heating mode icon
15	Ground warm mode icon
16	Air conditioning valve starting icon
17	Ground warm valve starting icon
18	WIFI icon
19	Door card icon
20	Temperature display area
21	Winding speed display area (More grids means faster speed)
22	Temperature setting
23	Automation mode icon
24	Timing switch display area
25	Down button
26	Six time intervals display area
27	Outdoor temperature icon

Keynote description

Power button: Short press the switch instrument under on-power and short press to exit present settings under setting mode.

Timing button:

1. When the selection function is a timing version, the timing switch option is set by short press of the time setting. The timing switching option is set by long press of the starting or by shutting down the timing function.

2. When the selection function is a time-period version, short press the start-up time to control or cancel the time-period control; long press the timing key to set the time-period and the setting temperature.

3. Choose no time mode and the timing key is of no use.

When setting time period, the switch mode is set by heating and refrigeration which can be set separately at different time and temperature. Short press wind speed key to switch the weekdays: Mon.-Fri. (workdays) and Sat.-Sun (weekends) for unified time settings.

1	Power button
2	Timing button
3	Setting button
4	Up button
5	Wind speed button, long press to lock keyboard
6	Week display area
7	Manual mode display
8	Timing mode display

Mode key: Short press mode key to switch the working mode, which is divided into ventilation mode, refrigeration mode, coil heating mode, coil heating + ground heating mode, and ground heating mode.

1. When the host controller is connected through 485, the corresponding mode can be set according to the present operation mode of the host. If the host is in refrigeration mode, the short press of M key will not be able to switch to uncooled mode. If the host is in heating mode, the short press of M key will not be able to switch to non-heating mode.

2. When the host 485 connection is not used, the usable mode can be switched.

3. The mode switching above is based on the internal mode fixed function switching mode. If the mode is fixed to the air conditioning state, mode switching only includes ventilation, refrigeration and coil heating. If the mode is fixed as air conditioning and floor heating, it is then the ventilation mode, refrigeration mode, coil heating mode, coil heating + floor heating mode and floor heating mode. If the mode is fixed to the ground heating mode, it cannot be switched to other modes. (Air-conditioning + floor heating is used when connecting 485, as there are no separate air-conditioning and floor heating in Dantwerton)

Long press M key to start Beijing time and weekday settings.

Downward key: adjust the setting temperature under no-settings, and make downward under settings.

Upward key: adjust the setting temperature under no-settings, and make upward under settings.

Wind speed key: Short press to adjust wind speed. The wind speed is DC 5 speed and AC 3 speed, and automatic control of the speed state. Long press the speed key to lock or unlock the keyboard.

Special function combination key:

- The output voltage of each gear is 4.5V if it is shown 450. The output voltage of each gear is switched to the next gear by pressing wind speed key, and the data is adjusted by pressing upper and lower keys. The data is added or reduced to 5. After setting, the output voltage of each gear is quit by pressing the power key.
- Start standard parameter settings by long pressing M key after shutdown (see setting table below)

No	Function	Data	Function	Default	Note
1	485Communication	0-99		1	

	address				
2	Location selection of temperature sensor	0-1	0 for built-in ; 1 for external	0	Not supported now
3	Set max. temperature value	Min. -60		35	
4	Set min. temperature value	0-max.		16	
5	Temperature adjust	+ -9°C	+ for plus -for minus	0	
6	Temperature control backlash	1.0-5.0		1	
7	Door card	0-1	Not supported		Not supported
8	Anti-frozen	0-1	0 for off; 1 for on	0	After opening anti-freezing and shutting down, start at ≤4°C and stop at ≥7°C
9	Reset	1-2	1 for normal 2 for reset	1	

LWTD8686D Temperature Controller Operation Manual

Assemble and connection:

Step 1: Cut off power supply of all control systems and equipment.

Step 2: Take out the iron plate as shown in the figure.



Step 2: Gently remove the thermostat by hand



Step 3: Take the screw from the packing box and fix the iron plate to the wall of the dark box according to the graphic direction



Note: When the installation is completed, the protective film on the LCD screen of the thermostat should be removed before it is used formally.

Connection diagram:

L	N					GND	VSP
1	2	3	4	5	6	7	8

Step 4: Incline according to the arrow direction, in the order of first ① and then ②.

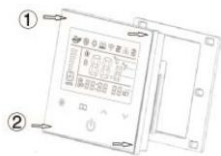

Disassembly steps

Step 1: Insert in the groove at the bottom of the plastic shell of the thermostat, and gently rotate the two sides 180 degrees to get rid of the iron plate.

Fault handling:

Statement: Maintenance of the products is limited to professional and technical personnel.

Description	Handling
Cannot start	<ol style="list-style-type: none"> 1. Testing whether L, N power supply is normal and connection is reliable. 2. Check whether the switch buttons are flexible and effective
Display of garbled code	Check whether metal particles and other impurities enter the controller
Fuse burnt	<ol style="list-style-type: none"> 1. Check connection 2. Change power source panel
No output with normal display	<ol style="list-style-type: none"> 1. Check working mode 2. Check temperature setting 3. Check wire connection
Remote control failure	<ol style="list-style-type: none"> 1. Check controller battery 2. Change remote controller
Discontinuous working	Check output wires, Whether the connection post is compacted or not

Warranty and after-sales service:

Warranty: The product quality warranty period is 18 months, calculated from the date of sale. Note: LCD scratch, broken. The damage caused by improper disassembly and assembly is not within the scope of warranty.

After-sale service: All our products can enjoy life-long after-sales service according to the regulations, but if the warranty period exceeds or the after-sales service caused by non-product quality problems, the company will charge a certain fee according to the circumstances.

Packaging accessories:

Product packaging box	1
Product description	2
Mounting screws	2
Product Qualification Certificate	1
Metal mounting plate	1

Technical Indicators:

1. Temperature induction: Temperature Sensors
2. Temperature control accuracy: $\pm 1^{\circ}\text{C}$
3. Standby power: $< 1\text{W}$
4. Terminal: wires $< 2.5\text{mm}^2$ is connectable
5. Frame: PC+ABS anti-burnt plastic
6. Geometric dimension: $86 \times 86 \times 15\text{mm}$ (W×H×T)
7. Installation hole spacing: 60mm (standard)
8. Protection level: IP30
9. Input voltage: AC220V/50Hz

